



# EXECUTIVE OVERVIEW

**Sensoscientific**®  
Environmental Monitoring

# ABOUT

---

## IoT Environmental Monitoring

Since 2005, SensoScientific has been at the forefront of Internet of Things (IoT) technology and innovative environmental monitoring. We focus on providing superior products, services, and calibration to help meet regulatory standards and improve operational efficiencies to meet compliance.

As the preferred environmental monitoring system for prominent healthcare facilities, GPOs, universities, and restaurant chains across the U.S., our fully automated monitoring system meets even the strictest regulatory requirements. Our ISO/IEC 17025 certified and A2LA Accredited Calibration Lab provides NIST Traceable probes and automatically uploads Calibration Certificates to the SensoScientific Cloud for immediate use.

As an ISO 9001 certified company, our quality management system ensures that we are in complete control of our solution from product development to installation and support. We assemble, test, and certify all products and utilize in-house trained support technicians, engineers, and developers. This helps ensure seamless system functionality with zero dependencies on third party manufacturers.

Our headquarters are in Simi Valley, CA but our products can be found around the world.



# HOW IT WORKS

---

## The Internet of Things (IoT)

Sensors piggyback off your existing Wi-Fi to upload data to the cloud and send you alerts & notifications. No need for costly external servers, tedious software installations, or extensive maintenance.

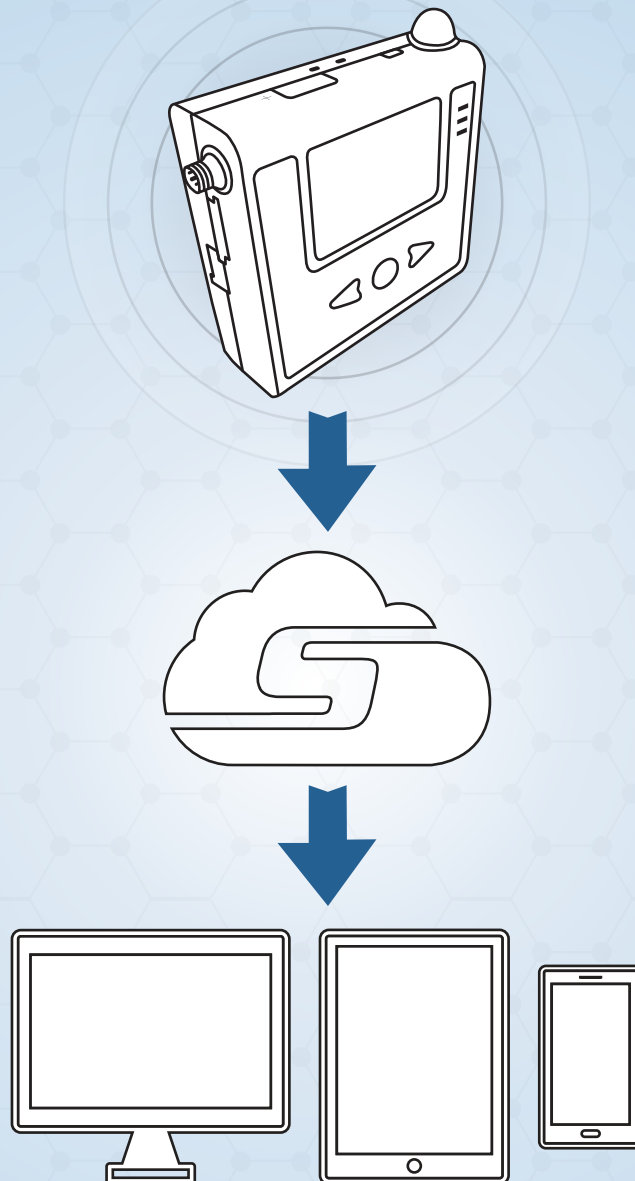



# VALIDATED CLOUD PLATFORM

## Your Data Moves With You

In partnership with the Microsoft® Azure cloud platform, SensoScientific utilizes bank-grade security to provide unparalleled reliability and security. Your data moves with you, whether its is at home, the office, or on the road — access your data from anywhere, 24/7.

## Comprehensive Reporting

Many different reports for many different needs. The SensoScientific Cloud has just about every report option you need to meet compliance.

- ✓ Monthly, Weekly and Daily Reports
- ✓ Two-Point and Monthly Compliance Reports
- ✓ Automatic Reports by Email
- ✓ Alert, Root Cause, and Correct Action History



## Notifications & Escalation

Through the cloud, you can receive notifications, establish escalation, and customize your alert preferences.

- ✓ Email
- ✓ Voice
- ✓ Text & SMS
- ✓ Fax
- ✓ Pager



# A2LA ACCREDITED CALIBRATION



## Fully Accredited

Our A2LA Accredited Calibration Lab provides NIST Traceable probes and uploads Calibration Certificates to the SensoScientific Cloud. Through the Cloud, you can view, print, and download your current and archived certificates — they are always accessible!

## SensoCal On-site Calibration

SensoScientific's On-site Calibration Service is the next level of personalized calibration. With this service, our ISO/IEC 17025 Certified Calibration Technicians go straight to your doorstep to recalibrate probes, perform device diagnostics, and prepare on-the-spot NIST Traceable Certificates for immediate use.

## SNAP Calibration

SensoScientific SNAP Calibration program is a convenient and cost-efficient solution to meeting regulatory compliance. SensoScientific automates calibration requirements by sending you freshly calibrated, NIST Traceable, and A2LA Accredited probes in the mail then uploading your Calibration Certificate to the Cloud.



# DEVICE-LEVEL COMPLIANCE

## Designed to Exceed Compliance

- ✓ CDC (Center for Disease Control & Prevention)
- ✓ VFC (Vaccines for Children)
- ✓ The Joint Commission
- ✓ FDA (Food and Drug Administration)

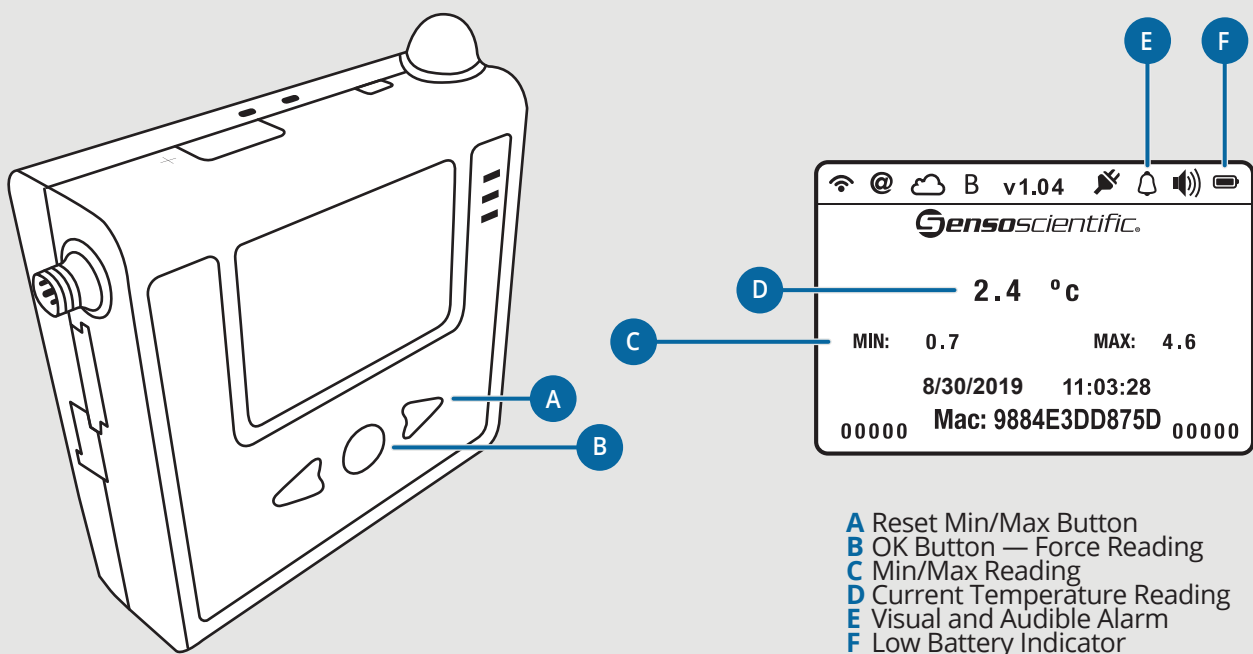

- 🔊 Digital Display
- 🔊 Detachable Probe with Glycol Buffer
- 🔊 Current and Min/Max Temperature Display
- 🔊 Ongoing A2LA Accredited and NIST Traceable Calibration Certificates
- 🔊 4000 Buffered Readings at Device-Level
- 🔊 Audible Alarms for Temperature Excursions
- 🔊  $\pm 0.5^{\circ}\text{C}$  Accuracy
- 🔊 AC Power Supply
- 🔊 5- to 15-Minute Adjustable Logging Intervals
- 🔊 Automated Reporting - Monthly Min/Max, Two-Point Monitoring, and more!

# OVER-THE-AIR TECHNOLOGY

---

## Future-Proof Your Monitoring System

In the latest OTA series, SensoScientific sensors combine the simplicity, accuracy, and reliability of environmental monitoring devices with powerful Over-the-Air firmware.



### Remote, Automatic Updates

Devices update automatically via a Wi-Fi connection, making environmental monitoring software updates more streamlined than ever before.



### Expand Product Life Span

Device software is kept up-to-date even after purchase, lengthening sensor life span — no need to replace outdated devices every few years.



### 100% Secure

SensoScientific utilizes FIPS compliant, bank-grade security to provide fully encrypted software updates with the power of the Microsoft® Azure cloud platform.



### Scalable and Cost Efficient

OTA firmware upgrades fleets of sensors with no downtime, protecting your bottom line and phasing out costly upgrades.



### No Performance Disruptions

Sensors remain fully functioning and interactive during OTA updates, continuously monitoring and recording real-time data.

# ENTERPRISE SCALABILITY



## Products for...

### Every Application

Temperature  
Vaccine Temperature  
Humidity  
Differential Pressure  
Light  
Open/Close Dry Contact  
Water Leak  
CO<sub>2</sub>  
Universal, 4-20mA

### Every Industry

Hospitals  
Blood Banks  
Vaccines  
Dietary  
Labs  
Pharmacies  
Life Sciences  
Clinics  
In Transit  
Surgery Centers  
Oncology Centers  
Warehouses  
Animal Labs  
Schools  
Restaurants





# REMOTE, RELIABLE SUPPORT

---

## No Matter Where You Are

SensoScientific provides the highest level of support to our partners around the world.

- ✓ 24/7 Support
- ✓ Interactive Ticket Submission
- ✓ Online Training Videos
- ✓ Live Weekly Webinars
- ✓ User Guides and Documents
- ✓ On-site Installation
- ✓ Carefree+ Membership Exclusives
  - + Health Checks
  - + Annual On-site Maintenance
  - + Battery Replacements
  - + Extended Warranty

## CONTACT US

Phone: (800) 279-3101  
Fax: (888) 238-6002  
[salesinfo@sensoscientific.com](mailto:salesinfo@sensoscientific.com)



685 Cochran Street, Suite #200  
Simi Valley, CA 93065  
© SensoScientific, Inc. | All Rights Reserved