

CompX RegulatorR

Installation instructions

RegulatorR

Thank you for purchasing the CompX RegulatorR. RegulatorR is an innovative solution for locking cabinet doors and drawers. It can mount to any cabinet door or drawer with a material thickness of 1/32" to 1-7/16".

Powered by 2-AAA batteries (included), RegulatorR operates using a 4 to 8 digit code. Operation is simple: type a valid code and press ENTER. Then just turn the lever to the locked or unlocked position.

RegulatorR is easy to install, and offers:

- ◆ Programmable user and supervisor codes
- ◆ Programmable modes of operation
- ◆ Programmable reset features

RegulatorR is intended for interior use only.

Operating Temperature: 50°F - 120°F
(10°C - 48°C)

Note: it is strongly recommended that batteries be replaced on an annual basis. In the event the batteries should die, they can be replaced via the external battery compartment. Please use high quality alkaline batteries for longest battery life.



RegulatorR with self-locking



RegulatorR with manual locking



CompX Regulator

Installation instructions

Regulator[®]

Table of Contents

| | |
|--|-------|
| Packaged Components | 3 |
| Care and Cleaning | 3 |
| Powering Up and Battery Installation | 4 |
| Operating the Regulator | 5 |
| Programming Mode Entry | 8 |
| Changing the User Code | 8 |
| Changing the Supervisor Code | 9 |
| Resetting the Regulator | 9 |
| Programming Single Use/Standard Mode | 10 |
| Programming Single Use Timeout ON/OFF..... | 11 |
| Programming Security Timeout ON/OFF | 11 |
| Reset User Code to Factory Default | 12 |
| Technician Mode – Programming and Operation | 13 |
| Manager Mode – Programming and Operation | 14 |
| Additional User Programming (Add/Delete with and without Slot Numbers) | 15-17 |
| Part Number Descriptions | 17 |
| Replacement Parts | 18 |
| SlamCam Wedge Strikes | 18 |
| Cam Accessories | 19 |
| Mounting Template | 20 |

CompX Regulator

Installation instructions

Regulator[®]

Packaged Components

CompX Regulator[®] is offered in two versions: Manual Lock and Self Lock. Packaged kit contents will vary depending on the version. Both have the required AAA alkaline batteries preinstalled.

Manual Lock Version contents:

Manual Regulator Lock Assembly
Hardware kit, which includes:

- One Offset locking cam
/ One Straight locking cam*
- FlexaCam adapters (three sizes)*
- One fastener with washer
for the cam retention*
- Three different fasteners
for housing mounting*
- Double D cylinder washer
and cylinder nut*

Self Lock Version contents:

Self Locking Regulator Lock assembly featuring SlamCAM

Hardware kit, which includes:

- Slam Cam Bolt assembly*
- Three fastener with washers
for the cam retention*

*One fastener for attaching
housing to surface*

*Double D cylinder washer
and cylinder nut*

*SlamCam spacer discs
(Four different thicknesses)*

*Two Wedged Strikes (one 1/2"
and one 5/8" thick unit)*

*Two wood screws for fastening
strikes to cabinet*

Each lock contains Two green stickers which have information printed on them needed for resetting Regulator lock. In the event Regulator needs to be reset, one green sticker is placed on the back of the device. The remaining green sticker should be saved in a safe and secure location for future reference. (See page 9 for reset instructions.)

To locate serial number of your CompX Regulator: Serial number is located on the included green decal. In addition, the long edge of the Regulator may have the serial number laser etched into it.



Care and Cleaning

To clean the Regulator surface, apply non-acid based cleaner to a clean cotton cloth; do not spray cleaner

directly on the Regulator. Wipe down keypad and its respective housing surfaces of excess cleaner.

CompX Regulator

Installation instructions

Regulator[®]

Powering Up and Battery Installation

CompX Regulator[®] is shipped with two AAA batteries. While Regulator features a low battery indicator, annual battery replacement is recommended. Mixing batteries of different chemistries could damage the Regulator resulting in lock failure.

To power up Regulator, remove the red tag. Lock is now ready for use. A T-15 pin in head Torx[®] (6-lobe) will be required to remove the battery cover. (Not Included)

To change batteries:

1. Loosen the retaining screw.
2. Remove battery cover.
3. Press CLEAR 5 times.
4. Insert new batteries as shown in the illustration.
5. Reinstall battery cover, tighten retaining screw by hand tool. **Do not use a powered tool to tighten.**



CompX RegulatorR

Installation instructions

RegulatorR

Operating the RegulatorR – Introduction

CompX RegulatorR® is easy to program and operate. Type the user code (factory default **1234**) and press **ENTER** to lock or unlock the cabinet.

The supervisor can change operating codes, modes and restore lock settings.

While RegulatorR is easy to program, we highly recommend reading the complete programming instructions

prior to making any changes. Remember to keep track of any programming changes.

Button locations, indicator lights and knob referenced in the programming instructions are shown below

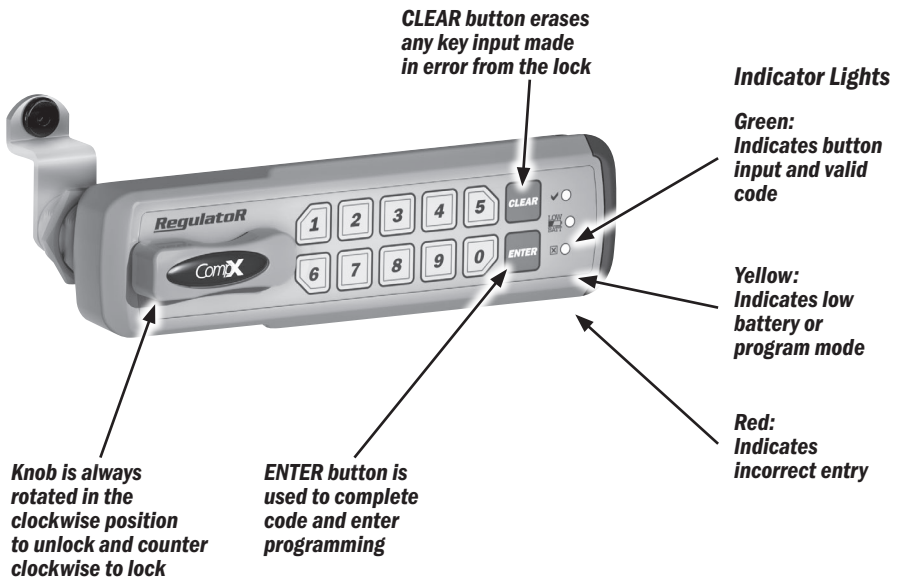

CompX Regulator

Installation instructions

Regulator[®]

Operating the Regulator – To operate the Self lock version of Regulator



CompX Regulator is offered with Self Lock featuring SlamCAM. If your lock is the Self Lock version, follow the directions below to unlock and lock the Regulator.

To operate the standard Self Lock version of Regulator:

Type a valid code, press ENTER and rotate knob clockwise 90°; hold knob until door or drawer is open. Release knob, Regulator knob will return to the locked position. Door or drawer can be closed at any time.

CompX Regulator

Installation instructions

Regulator[®]

Operating the Regulator – To operate the Manual lock version of Regulator



CompX Regulator is offered in a Manual Lock version. If your lock is the Manual Lock version follow the directions below to unlock and lock the Regulator.

Standard Mode

To operate Manual Lock version of Regulator in **Standard Mode**:

To **unlock**, enter a valid code, press ENTER and rotate knob 90° to the clockwise position.

To **lock**, rotate knob to the counter clockwise position.

Single use Mode

In single use mode the user creates any 4-8 digit code and uses it to lock and unlock the Regulator.

To operate Manual Lock version of Regulator in **Single Use mode**:

To **lock**, enter any 4-8 digit code, press **ENTER** and rotate knob 90° to the counter clock wise position.

To **unlock**, enter the same 4-8 digit code that was used to lock the regulator and rotate knob to the clockwise position.

To operate Manual Lock version of Regulator in **Single Use, Code Verification mode**:

To **lock**, enter any 4-8 digit code, press **ENTER**. The Yellow LED will blink in a 2 blink pattern. Enter the same 4-8 digit code, press **ENTER**. *This code MUST MATCH the code entered the first time.* Rotate knob 90° to the counter clock wise position.

To unlock, enter the same 4-8 digit code that was used to lock the Regulator and rotate knob to the clockwise position.

CompX Regulator

Installation instructions

Regulator[®]

RegulatorR – Programming Mode Entry

To enter programming mode you must know the supervisor code. The default supervisor code is **12345**. Once in programming mode, multiple changes can be made prior to exiting programming.

There is a 10 second programming time limit between each step. If RegulatorR times out or an error is made, programming will end and you will need to enter programming mode again.

1. Lock must be in the **locked** position prior to entering programming mode.

2. Type supervisor code and press **ENTER**. Rotate the knob to the **unlocked** position and press and hold **ENTER** for 3 seconds (**yellow** indicator light will illuminate).

- If product is Self Lock with the SlamCAM feature you can now let go of the knob.

3. With the **yellow** indicator light illuminated, programming can begin.

Changing the User Code

To change the user code, follow the steps on page 8 to enter programming mode.

The factory default user code is **1234** (User codes must be 4 to 8 digits in length.)

There is a 10 second programming time limit between each step. If RegulatorR times out or an error is made, programming will end and you will need to enter programming mode again.

1. Place RegulatorR into programming mode (see page 8).

2. Press **1** and then press **ENTER**.

3. Type the current user code and press **ENTER**.

4. Type the new user code and press **ENTER**.

5. Retype the new user code and press **ENTER**.

6. If successful, the **green** indicator light will illuminate for 1 second.

Continue programming or press **9** and then **ENTER** to exit programming.

CompX Regulator

Installation instructions

Regulator[®]

Changing the Supervisor Code

To change the supervisor code, follow the steps on page 8 to enter programming mode.

The factory default supervisor code is **12345** (supervisor codes must be 4 to 8 digits in length.)

There is a 10 second programming time limit between each step. If Regulator times out or an error is made, programming will end and you will need to enter programming mode again.

1. Place Regulator into programming mode (see page 8).
2. Press **2** and then press **ENTER**.

3. Type the current supervisor code and press **ENTER**.
4. Type the new supervisor code and press **ENTER**.
5. Retype the new supervisor code and press **ENTER**.
6. If successful, the **green** indicator light will illuminate for 1 second.

Continue programming or press **9** and then **ENTER** to exit programming.

Resetting the Regulator

Regulator features a reset code which will restore the default supervisor code and user code. Regulator was shipped with reset stickers; one attached to the back of the Regulator and an extra sticker that should be saved in a safe and secure location for future reference.

To restore the factory default supervisor and user code, type the Reset Code assigned to the Regulator and press **ENTER**.

CompX Regulator[®] features several modes of operation. These functions can be changed using the following instructions with a valid supervisor code.

CompX Regulator

Installation instructions

Regulator[®]

Programming Single Use Mode / Standard Mode

Single Use Mode allows for a revolving user code so multiple people may use the lock without having to reprogram the Regulator each time.

Note: This mode **cannot** be used with Self Lock with SlamCAM.

Standard Mode Regulator operates with a fixed code. To change the code, follow the **Changing the User Code** steps on page 8.

To change the Regulator to Single Use or Standard Mode, follow the steps on page 8 to enter programming mode.

There is a **10** second programming time limit between each step. If Regulator times out or an error is made, programming will end and you will need to enter programming mode again.

There are two **Single Use Modes**: **Single Use Mode** and **Single Use, Code Verification Mode**. **Single Use Mode** requires the user to enter their single use code once. **Single use, Code Verification Mode** requires the user to

enter their code twice (and they need to match).

Please read through the entire instructions prior to beginning programming.

1. Place Regulator into programming mode.
2. To turn Single Use Mode "ON": type **51** and the press **ENTER**
3. To turn Single Use Mode, Code Verification Mode "ON" type **512** and press **ENTER**
4. To return to **Standard Mode**: type **50** and press **ENTER**.
5. If successful the **green** indicator will illuminate for 1 second.

Note: Returning to **Standard Mode** will return the factory user default code to **1234**

Continue programming or press **9** and then **ENTER** to exit programming.

CompX Regulator

Installation instructions

Regulator[®]

Programming Single Use Timeout ON / Single Use Timeout OFF

Warning: Manual Lock - Single Use Timeout ON is a feature to prevent users from occupying a shared use locker or cabinet for a prolonged period of time. Turning this feature on will disable the user code after a programmable amount of time. After this time elapses, Regulator and can only be opened with the supervisor code.

To change the Regulator to Single Use Timeout ON or OFF, follow the steps on page 8 to enter programming mode.

There is a 10 second programming time limit between each step. If Regulator times out or an error is made, programming will end and you will need to enter programming mode again.

1. Place Regulator into programming mode (see page 8).
 - a. To set Timeout ON, type **2XX** and then press **ENTER**. (**XX** represents a time period from 04 - 12 in whole hours.)

OR

- b. To turn Timeout OFF, type **20** and then press **ENTER**.
3. If successful, the **green** indicator light will illuminate for 1 second.

Continue programming or press **9** and then **ENTER** to exit programming.

Programming Security Timeout ON / Security Timeout OFF

Warning: Security Timeout ON will disable the Regulator from use for 5 minutes when 5 invalid attempts to unlock Regulator occur. During this time, Regulator will not unlock with either the valid user or supervisor code.

To change the Regulator to Security Timeout ON or OFF, follow the steps on page 8 to enter programming mode.

There is a 10 second programming time limit between each step. If Regulator times out or error is made, programming

will end and you will need to enter programming mode again.

1. Place Regulator into programming mode see page 8).
 - a. To turn **Security Timeout ON**, type **11** and then press **ENTER**.

OR

- b. To turn **Security Timeout OFF**, type **10** and then press **ENTER**.

CompX Regulator

Installation instructions

Regulator[®]

Programming Security Timeout ON / Security Timeout OFF continued

2. If successful, the **green** indicator light will illuminate for 1 second. Continue programming or press **9** and then **ENTER** to exit programming

Reset User Code to Factory Default 1234 *(Does not apply to Single Use Mode)*

To reset the User Code to the factory default **1234** follow the steps on page 8 to enter programming mode.

There is a 10 second programming time limit between each step. If Regulator times out or error is made, programming will end and you will need to enter programming mode again.

1. Place Regulator into programming mode (see page 8).

2. Type **8888** and then press the **ENTER** button.

3. If successful, the green indicator light will illuminate for 1 second.

Continue programming or press **9** and then **ENTER** to exit programming.

CompX Regulator

Installation instructions

Regulator[®]

Technician Mode – Programming (Manual locking Regulator only)

When Technician Mode is ON, the programmed Technician Code can be used to unlock a locked **Single Use Mode** Regulator without erasing the existing single use code.

There is a 10 second programming time limit between each step. If Regulator times out or error is made, programming will end and you will need to enter programming mode again.

1. Place Regulator into programming mode (see page 8).
2. To turn Technician Mode ON: type **31** and then press **ENTER**.
3. Type the desired 4 to 8 digit Technician Code and then press **ENTER**.

4. Retype Technician Code and then press **ENTER**

5. **REMEMBER THIS CODE**

OR

To turn Technician Mode OFF: type **30** and then press **ENTER**

- ◆ If successful, the **green** indicator light will illuminate for 1 second.
- ◆ Press **9** followed by **ENTER** to exit Programming Mode

Technician Mode – Operation

Note: Regulator must be locked and in single use mode.

TO UNLOCK

1. Type the Technician Code and press **ENTER**.
2. Turn the knob clockwise 90° to the unlocked position (all three LED lights will have a rotating blinking pattern).
3. To relock & retain the single use code that already exists; rotate the knob 90° counter clockwise.

OR

To remove the existing single use code and leave the Regulator unlocked: Type the Technician Code and press **ENTER**.

Press **1** then press and hold **CLEAR** for 3 seconds.

CompX Regulator

Installation instructions

Regulator[®]

Manager Mode – Programming (Manual locking Regulator only)

When Manager Mode is ON, the programmed manager Code can be used to unlock a locked **Single Use Mode** Regulator and erase the existing single use code.

There is a **10** second programming time limit between each step. If Regulator times out or error is made, programming will end and you will need to enter programming mode again.

To turn Manager Mode **ON**

1. Place Regulator into programming mode (see page 8).
2. To turn Manager Mode **ON**: type **33** and then press **ENTER**.
3. Type the desired 4 to 8 digit Manager Code and then press **ENTER**.

4. Retype Manager Code and then press **ENTER**

5. **REMEMBER THIS CODE**

- Press **9** followed by **ENTER** to exit Programming Mode

To turn Manager Mode **OFF**

1. Place Regulator into programming mode (see page 8).
 2. To turn Manager Mode **OFF**: type **32** and then press **ENTER**.
- If successful, the **green** indicator light will illuminate for 1 second.
 - Press **9** followed by **ENTER** to exit Programming Mode

Manager Mode - Operation

Note: Regulator must be locked and in single use mode.

TO UNLOCK

1. Type the Manager Code and press **ENTER**.
2. Turn the knob clockwise 90° to the unlocked position
3. The single use code that existed to lock the Regulator has been erased.

CompX Regulator

Installation instructions

Regulator[®]

Add User Without Specifying Memory Slot

The **Supervisor Code** memory location is called **Slot 01** and the first **User Code** is called **Slot 02**.

- ◆ Any additional User Codes reside in memory slots 03-20.
- ◆ To add a user code without specifying a memory slot (03 -20), follow the steps on page 8 to enter programming mode.

User codes must be 4 to 8 digits in length and must be different from all existing codes (including Slot 01 Supervisor & Slot 02 User codes).

There is a 10 second programming time limit between each step. If

Regulator times out or an error is made, programming will end and you will need to enter programming mode again.

1. Place Regulator into programming mode (see page 8).
2. Press **410** and then press **ENTER**.
3. Type the new user code and press **ENTER**.
4. Retype the new user code and press **ENTER**.
5. If successful, the yellow indicator light will illuminate.

Continue programming or press **9** and then **ENTER** to exit programming.

Add User to Specific Memory Slot (03 – 20)

The **Supervisor code** memory location is called **Slot 01** and the first **User code** is called **Slot 02**.

- ◆ Any additional User Codes reside in memory slots 03-20.
- ◆ To add a user code to a specific memory slot (03 -20), follow the steps on page 8 to enter programming mode.

User codes must be 4 to 8 digits in length and **must** be different from

all existing codes (including Slot 01 Supervisor & Slot 02 User codes).

There is a 10 second programming time limit between each step. If Regulator times out or an error is made, programming will end and you will need to enter programming mode again.

1. Place Regulator into programming mode (see page 8).
2. Press **411** and then press **ENTER**.

CompX Regulator

Installation instructions

Regulator[®]

Add User to Specific Memory Slot (03 – 20) continued

3. Type memory slot to be added followed by **ENTER** (for memory slots 03 - 09, you must type leading "0" – e.g. "07" for slot 7)
4. Retype memory slot to be added followed by **ENTER**
5. Type the new user code and press **ENTER**.
6. Retype the new user code and press **ENTER**.
7. If successful, the **yellow** indicator light will illuminate.

Continue programming or press **9** and then **ENTER** to exit programming.

Delete User Without Specifying Memory Slot

The Supervisor code memory location is called Slot 01 and the first User code is called Slot 02.

- ◆ The additional user codes reside in memory slots 03-20.
- ◆ To delete a user code without specifying a memory slot (03 -20), follow the steps on page 8 to enter programming mode.

There is a 10 second programming time limit between each step. If Regulator times out or an error is made, programming will end and you will need to enter programming mode again.

1. Place Regulator into programming mode (see page 8).
2. Press **400** and then press **ENTER**.
3. Type the user code to be deleted and press **ENTER**.
4. Retype the user code to be deleted and press **ENTER**.
5. If successful, the **yellow** indicator light will illuminate.

Continue programming or press **9** and then **ENTER** to exit programming.

CompX Regulator

Installation instructions

Regulator[®]

Delete User From Specific Memory Slot (03 – 20)

The **Supervisor code** memory location is called **Slot 01** and the first **User code** is called **Slot 02**.

- ◆ The additional user codes reside in memory slots 03-20.
- ◆ To delete a user code from a specific memory slot (03 -20), follow the steps on page 8 to enter programming mode.

There is a 10 second programming time limit between each step. If Regulator times out or an error is made, programming will end and you will need to enter programming mode again.

1. Place Regulator into programming mode (see page 8).
2. Press **401** and then press **ENTER**.
3. Type memory slot to be vacated followed by **ENTER** (for memory slots 03 - 09, you must type leading "0" – e.g. "07" for slot 7)
4. Retype memory slot to be vacated followed by **ENTER**.
5. If successful, the **yellow** indicator light will illuminate.

Continue programming or press **9** and then **ENTER** to exit programming.

Regulator Part Number Descriptions

Example: **REG-S-L-3-BK**

REG = Regulator Standard Knob

REGS = Regulator Short Knob

Version:

S = Self-locking, featuring SlamCAM

M = Manual locking, standard CompX National cams

Mounting:

L = Left hand mount, door application
- hinge on left side when facing cabinet

R = Right hand mount door application
- hinge on right side when facing cabinet

V = Vertical mount door application
(keypad located above locking point)

T = Top vertical mount door application
(keypad located below locking point)

Cylinder Length:

1 = 7/16" cylinder length

3 = 1-3/16" cylinder length

5 = 1-3/4" cylinder length

Color:

BK = Matte black housing and knob

WH = Gloss white housing and knob

No suffix = Standard silver housing and knob

CompX Regulator

Installation instructions

Regulator[®]

Replacement Parts

REG-KIT-KNOB

Replacement knob kit

213005000000J

Replacement battery door

REG-KIT-KNOBS

Replacement short knob kit

344759000000J

Wedge strike kit

SlamCam wedge strikes

WEDGE 1 (1/2" Wedge)

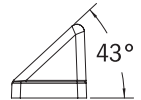
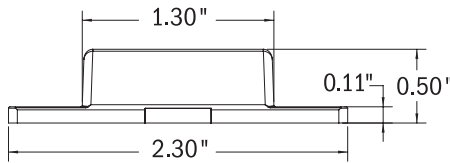
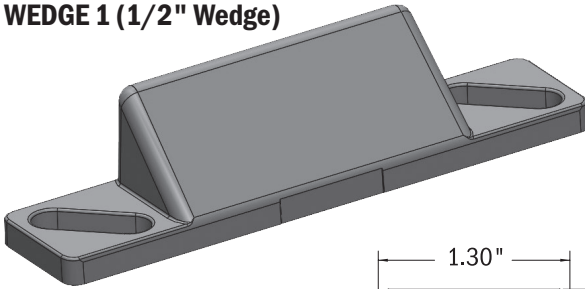

WEDGE 2 (5/8" Wedge)

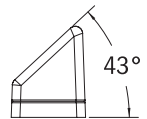
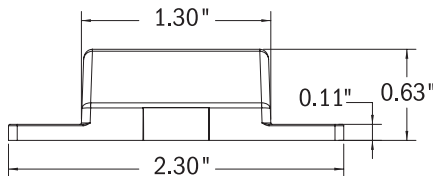
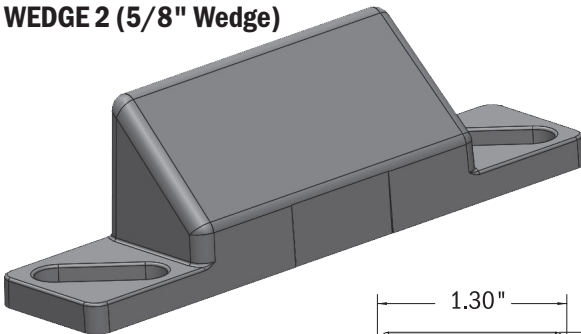

CompX Regulator

Installation instructions

Regulator®

Cam Accessories

SlamCAM spacer discs (if so equipped) can be inserted between the lock barrel

and SlamCAM mechanism to adjust the backset. See image below.



FlexaCam adaptors (if so equipped) can be attached to the cam on manual versions to provide up to 12 different

dimensional variations. See image below:



CompX Regulator

Installation instructions

Regulator[®]

Mounting Template

1"

WARNING: Print this page and measure the line above. It is **ONE INCH LONG**. If it measures less than or more than one inch, the template measurements also need to be scaled accordingly.

**FAILURE TO DO SO
COULD RESULT IN
MISDRILLED HOLES.**

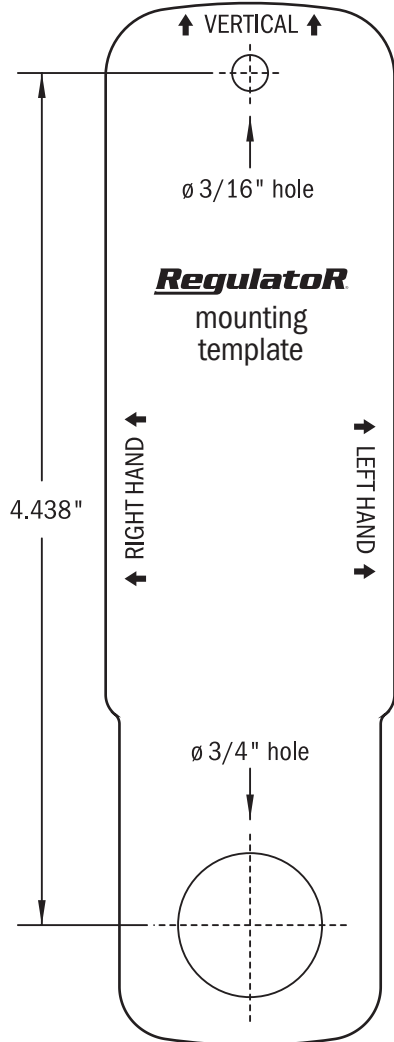

compregulator.com

Part #: 333153000000 REV G
Revision: 03052026

Copyright 2026 © CompX Security Products / 847.752.2500 / 715 Center St, Grayslake, IL 60030

Any companies and/or products referred to herein are marks or registered trademarks of their respective companies, owners and/or mark holders.